

Displacement Guide Requirements

APPLICATION:

Correcting web misalignment by pivoting a set of guide rollers about a fixed point to geometrically displace ([align](#)) the web. A displacement guide provides correction with minimal entry and exit web span requirements. It is ideal for applications with space limitations. It minimizes web stress to avoid compromising the material's integrity ([wrinkling](#)).

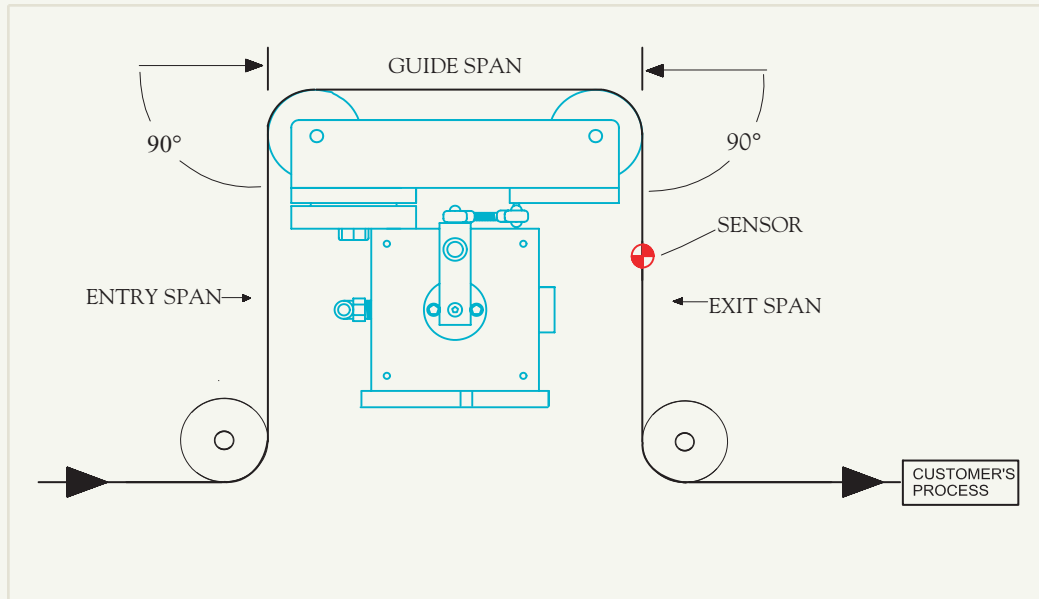

REQUIREMENTS:

- Entry and exit web spans must be parallel to each other and [perpendicular](#) to the plane of the guide's motion. Spans should be approximately 1/2 to 1x the maximum web width
- Web must enter and exit the guide at a 90° angle (however, $\pm 5^\circ$ is an acceptable tolerance)
- Guide span should be approximately 1x the maximum web width
- The air-flow sensor must be securely mounted after the guide's exit roller and within the first 1/3 of the exit span
- At least one idler roller must be located between the exit roller and the process (i.e. printing, laminating, die cutting) to avoid guiding directly into a process

RETROFIT REQUIREMENTS:

- Retrofitting or replacing an older ([hydraulic or electronic](#)) control system attached to an existing guide assembly with the Coast *All-Air* Control System
- Existing guide must be in good mechanical condition and must move freely-without bind
- Must be properly located and installed on a web processing machine. (See above requirements.) It may be necessary to relocate the guide to obtain the desired guiding results

Typical Displacement Guide Installation and Threading Options

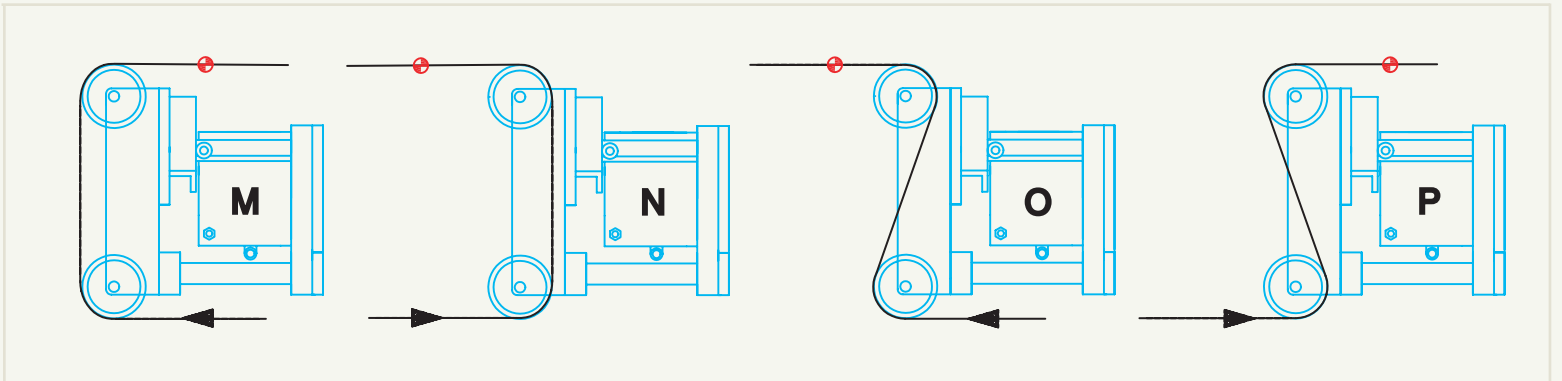
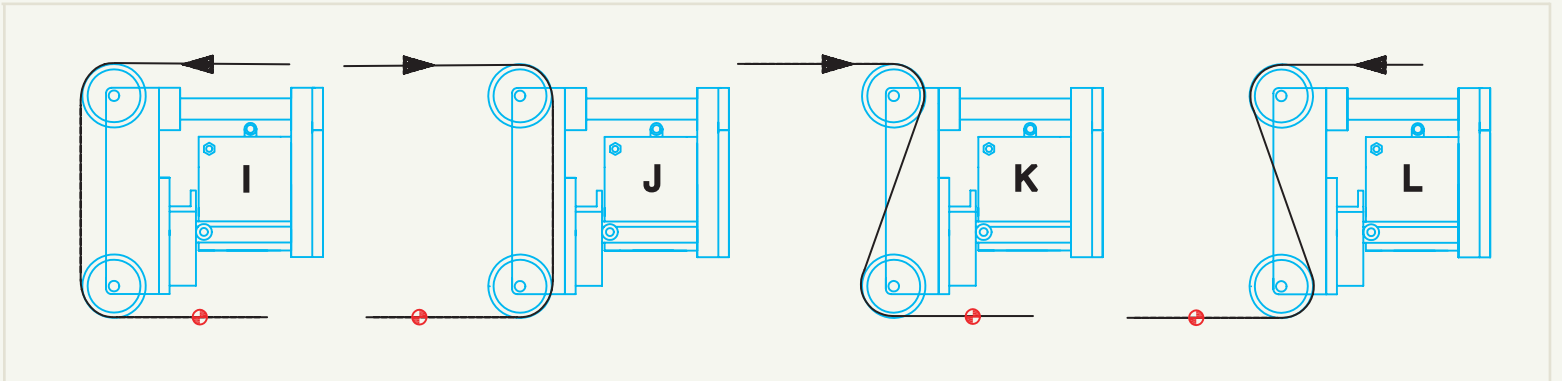
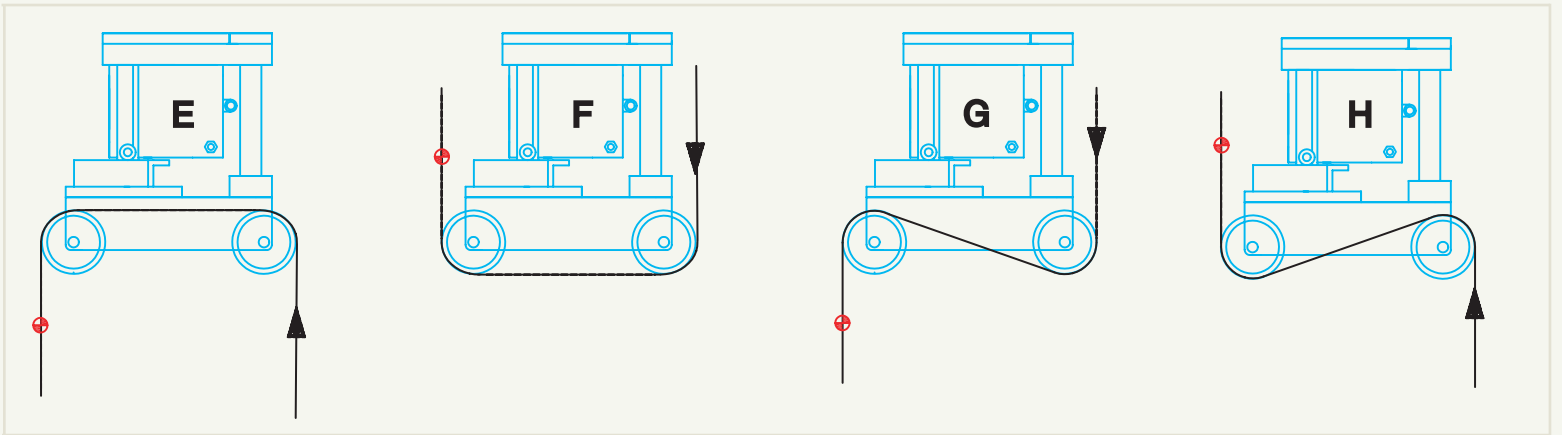
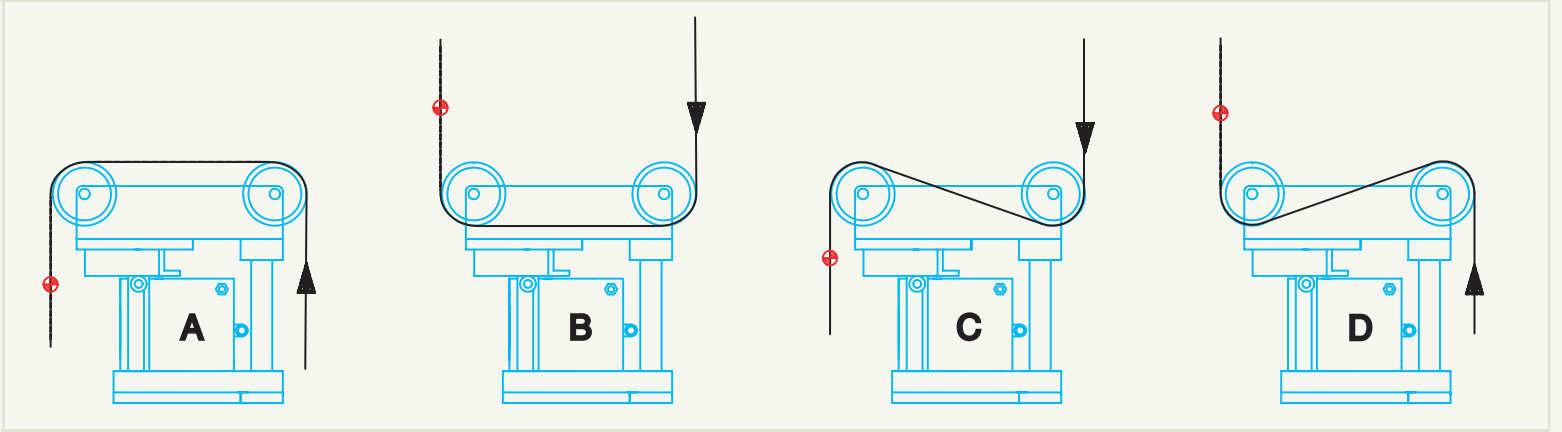

* Note: The air-flow sensor should be located as close to the exiting guide roller as possible and within the first 1/3 of the exiting span.

Typical Displacement Guide Applications

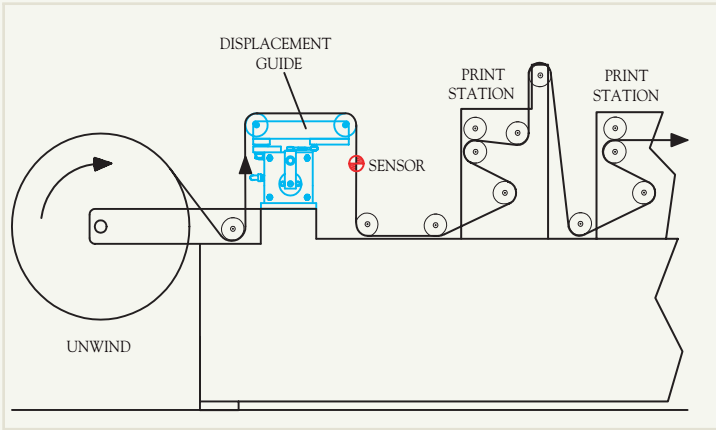

GUIDING INTO PRINTING ON A NARROW WEB PRESS

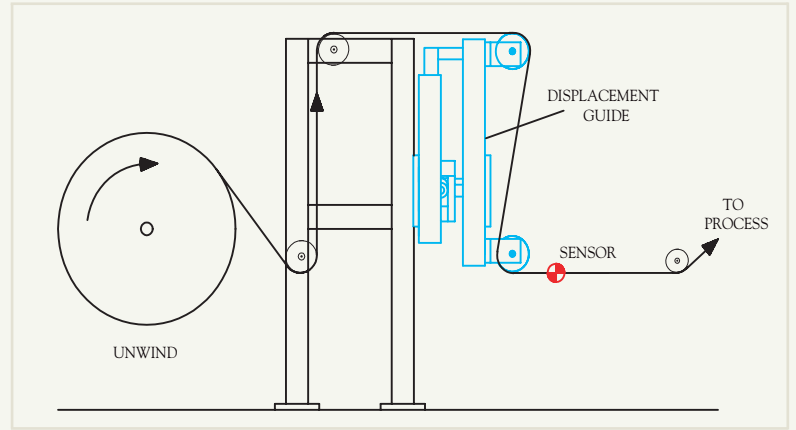

GUIDING INTO A PROCESS

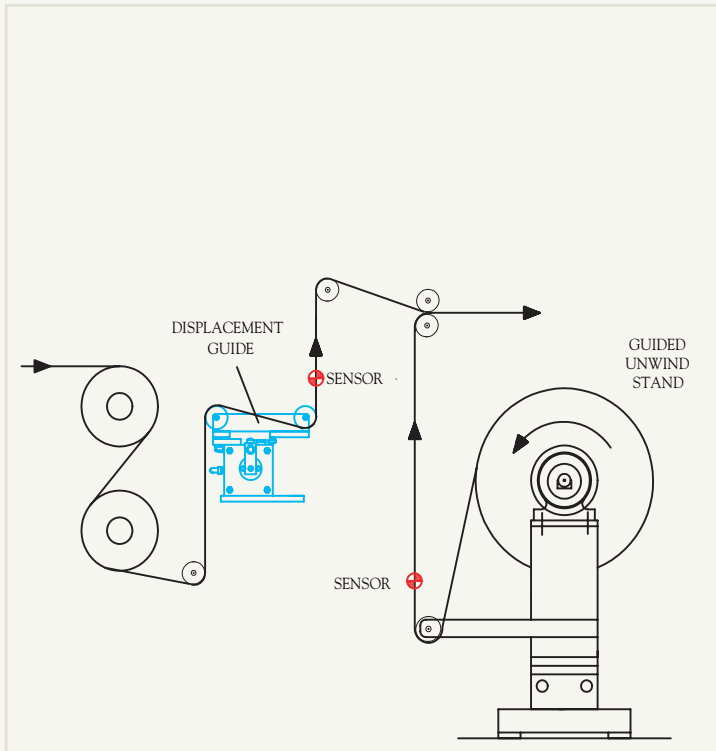

GUIDING INTO LAMINATING

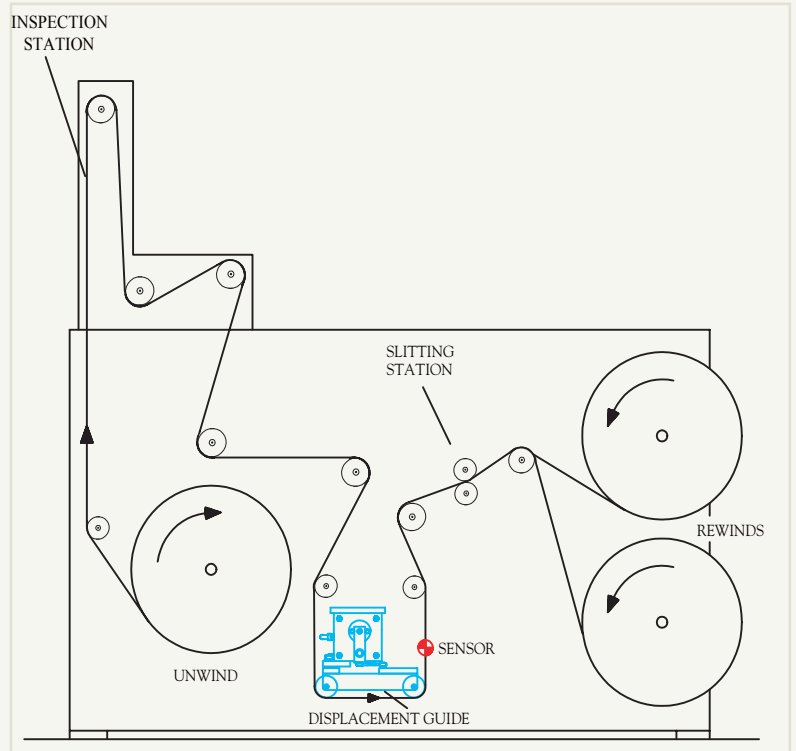

GUIDING ON A SLITTER/REWINDER/INSPECTION MACHINE

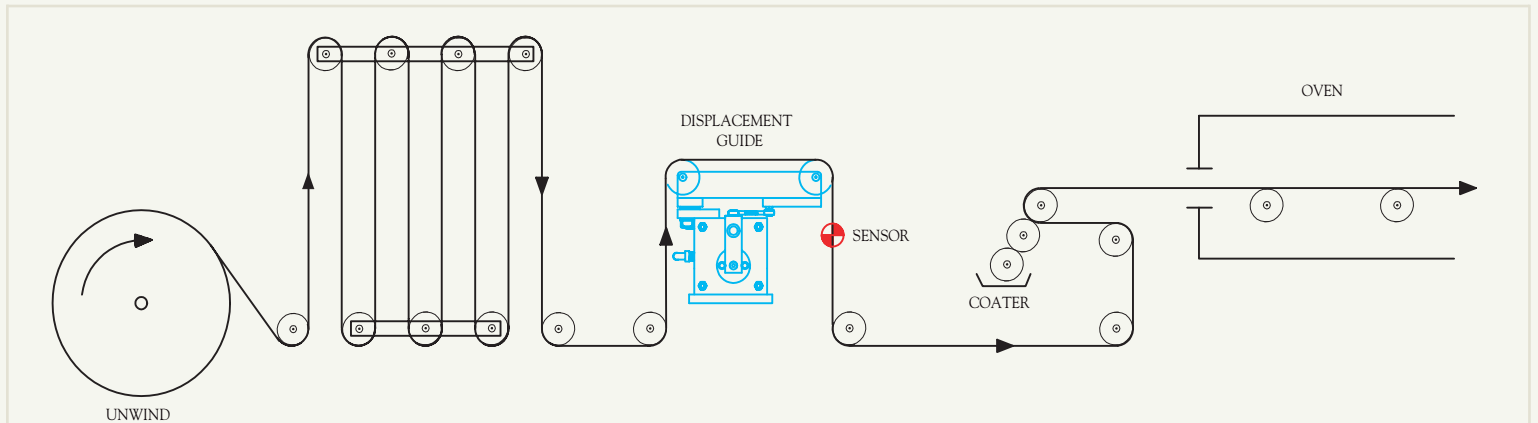

GUIDING INTO COATING